

ARTIZAN™ MAX FRP

Technical Data, Cleaning Instructions, Warranty, & Installation Instructions

Introduction

Protect and transform walls without compromise. Artizan™ Max FRP wall protection panels are digitally printed in stunning detail to achieve any vision and are engineered to withstand the toughest environments.

Max Design: Artizan Max FRP employs the most advanced print technology creating exceptional visual detail at 1000 DPI. The difference is smaller ink droplets and many more of them.

Max Defense: Every wall protection panel is top coated with an aluminum oxide ceramic coating that was developed for the flooring industry. Marlite is the first to apply this topcoat technology to wall panels.

Applications & Uses

Uses:

- Wall protection - a better alternative to laminate, rigid vinyl, wallcovering, paint
- Material representation - marble, stone, brick, wood and more
- Branding, graphics and murals

Application:

Healthcare Facilities	Fitness Areas
Schools & Universities	Kitchens
Hotels & Casinos	Merchandising Displays
Houses of Worship	Service Centers
Transportation Terminals	Hallways & Corridors
Office & Residential Buildings	Lobbies
Fitness Centers & Spas	Lounges
Retail	
Food Services	
Grocery, Convenience & Drug Stores	
Sports Arenas	
Dining Rooms	
Patient Rooms	

Panel Specifications

1. Marlite Artizan™ Max FRP Panels are manufactured using a homogenous mixture of calcium carbonate, fiberglass, resin, digitally printed layer, and topped with an aluminum oxide ceramic coating.
2. Panels shall have a smooth texture front side. Panel color shall be per specification. Panel back side is smooth and may possess slight imperfections that do not adversely affect performance or physical properties and are not cause for rejection.
3. Panel quality standards are:
 - Panel thickness:** .090" +/- 10%
 - Width:** 48" +/- 1/8"
 - Length:** specified length +/- 1/8"
 - Diagonals:** not to exceed 1/8" for 8' panels or 5/32" for 10' panels
4. Artizan™ Max wall panels are precision square cut to ensure 90 degree angles. Simply slide panels together. Division molding is no longer required.
5. Panels shall be installed in strict accordance with Marlite Artizan™ Max FRP Installation Instructions. Failure to do so will be at the sole risk of the installer.

ARTIZAN™ MAX FRP

Technical Data

Physical Properties	Test	Result
Hard Body Impact	ASTM C1629	Level 3, Highest level
Surface Abrasion	ASTM C1629, D4977	Level 3, Highest level
Impact Indentation	ASTM C1629, D5420	Level 3, Highest level
Water Absorption	ASTM D570	Avg. rate of absorption is 0.026
Tensile Strength	ASTM D638	8.0 x 10 ³ psi
Tensile Modulus	ASTM D638	9.43 x 10 ³ psi
Thermal Expansion	ASTM D696	1.63 x 10 ⁻⁵ in/in/°F
Flexural Strength	ASTM D790	1.7 x 10 ⁴ psi
Flexural Modulus	ASTM D790	6.0 x 10 ⁵ psi
Stain Cleanability	ASTM D1308 LD-3.1	9
Hoffman Scratch Scrape Adhesion	ASTM D2197	Pass, Max load (10kg) reached with no scraping
Barcol Hardness	ASTM D2583	29
Mold & Mildew Resistance	ASTM D3273	Pass
Cross Hatch Adhesion	ASTM D3359	5B 0% removed
Taber Abrasion	ASTM D4060	1,372 cycles
MEK Swipe Test	ASTM D4752	Pass
Standard Specification	ASTM D5319	Meets
Graffiti Resistance	ASTM D6578	Average rating 6.7
Surface Burning	ASTM E84	Class A and Class C
Fungal and Bacterial Resistance	ASTM G21/G22	Pass, No growth at 21 days

Approvals & Certifications

- Class III/C Fire Ratings per ASTM E-84 flame spread and smoke development tests
- Class I/A Fire Ratings per ASTM E-84 flame spread and smoke development tests
- ASTM D3273-16 Mold and mildew resistant
- Meets USDA/FSIS requirements
- GreenGuard Certification
- ASTM G21/G22 Fungal and bacteria resistant
- ASTM D1629 Hard body impact, level 3
- ASTM D5420 Indentation, level 3
- ASTM D4977 Surface abrasion, level 3

Storage & Preparation

Carefully inspect all panels prior to installation. Notify Marlite at once if panels are deemed unacceptable. Marlite Artizan™ Max FRP Panels should be stored indoors on a flat, clean, dry surface for at least 48 hours prior to installation. Room and material (panels and adhesive) temperature should both be at or near 70°F at the time of installation. Marlite Artizan™ Max FRP installs quickly and easily over most existing surfaces.

Installation Overview

Safety – use eye protection. Wear filter mask to cover nose and mouth, especially when cutting panels.

Tools Required – Table saw or circular saw with fine-tooth blade, caulking gun, rule/tape, drill, file, hammer, laser level, horses/support.

See *Marlite Artizan™ Max FRP Installation Instructions for complete details.*

Accessories

- Marlite PVC Trim Molding with integral, colors, 8' & 10' lengths.
- Marlite Aluminum Trim Molding with integral, matching colors, 8' lengths.
- Color matching silicone sealant, 10oz cartridges.
- Marlite Stainless Steel and PVC Outside Corner Guards, 8' & 10' lengths.
- Marlite PVC Base Molding, 10' lengths.
- Marlite brand C-551 FRP Adhesive or Advanced Polymer Adhesive
- Marlite brand Silicone Sealant MS-250 Clear & MS-251 White

Serviceable Temperature Range

Marlite Artizan™ Max FRP is intended for indoor use only.

Artizan™ Max FRP may discolor near heat sources – such as ovens, fryers, heat lamps and toasters.

ARTIZAN™ MAX FRP

Cleaning Instructions

Overview

For best results, engage in a regular cleaning schedule to avoid dirt build-up. As a general rule, any mild cleaner applied with a sponge or soft brush is safe and effective. Avoid using any cleaner or stain remover considered abrasive or containing chlorinated hydrocarbons or aromatic hydrocarbons.

Cleaning Agents

The following cleaning agents have been tested and approved. Be sure to test any cleaning agent not appearing on this list in a small, inconspicuous area first.

- Clorox Clean-Up with Bleach
- Pine Sol
- Simple Green
- Mrs Meyer's Clean Day
- Formula 409 Multi-Purpose Cleaner
- Fantastik
- Alcohol Wipes
- Goof Off All Purpose Cleaner
- Mr Clean Magic Eraser
- Windex

Application Method

Apply the cleaning agent with a sponge or soft brush, working it across the surface in a scrubbing or circular motion. Rinse thoroughly using cold water.

For Graffiti and Other Stubborn Stains

If the aforementioned cleaning agents fail to remove graffiti or other stubborn stains, the following more powerful agents have been tested and approved for use with caution:

- Misty Vandalism Mark Remover
- Censor Vandalism Mark Remover
- Goof Off Graffiti Remover
- Denatured Alcohol
- Alcohol Wipes

Please note: These powerful cleaning agents are flammable. Be sure to take proper precautions when using these or any flammable materials.

ARTIZAN™ MAX FRP Warranty

A Limited Warranty for Marlite Class A and Class C (FRP) fiberglass reinforced panels as manufactured by Marlite Inc. 1 Marlite Drive; Dover Ohio 44622 is warranted for a period of three (3) years from the date of purchase to be free from substantial defects. Panels covered under this warranty are warranted for a period of three (3) years from date of purchase to:

1. Be free from substantial defects in material and workmanship.
2. Not rot, rust, corrode, develop structural surface cracks, or require painting or refinishing. Panels covered under this warranty are not specifically covered in any other Marlite Inc. warranty. Marlite, Inc. will, at its option, upon documentation and verification of failure, repair or replace the panels, without charge, with the above referenced product if it fails due to the above defects.

This warranty does not include labor costs or miscellaneous costs for removal and/or replacement of material.

This warranty applies only to panels stored, applied, installed, and used in accordance with manufacturer's recommendations and technical bulletins and with recognized standards of construction.

This Warranty does not cover defects caused by:

1. Improper installation (non-conformance with recognized standards of construction). Failure due to any adhesive, caulk, or other accessory.
2. Damage (not resulting from defects) while in possession of the Customer.
3. Unreasonable use (including failure to provide reasonable and necessary maintenance). Normal pigmentation fading or abnormal fading due to exposure to ultraviolet rays. Damage or loss due to acts of God, improper storage, catastrophic events such as fire, hurricane, and flood. Marlite, Inc. disclaims any warranty, expressed or implied, which is not contained herein, including any implied warranty of merchantability, or fit for a particular purpose. Marlite, Inc. shall not be liable for consequential, incidental, or punitive damages. This warranty is the sole warranty provided for and with Marlite's fiberglass reinforced plastic panels and replaces all previous warranties. To present a claim under this warranty, purchaser must send all information to:

Marlite, Inc.
Attention: Customer Service
1 Marlite Drive, Dover Ohio 44622
330-343-6621
MLcustomerservice@marlite.com

ARTIZAN™ MAX FRP

Installation Instructions

Statements expressed in this technical bulletin are recommendations for the application of Marlite brand products as outlined and illustrated under normal conditions of installation. The recommendations provided in the bulletin represent our best judgment based on our experience with normal applications. Unless prior approval is obtained in writing from Marlite, any deviation from these recommended procedures shall be at the sole risk of the installers. Carefully inspect all panels. If a panel is defective, notify the Marlite Service Center or Distributor nearest you at once. Failure to do so shall be at the sole risk of the installer. Do not store Marlite Artizan™ Max FRP Panels outside exposed to the weather and its elements.

Important – Read complete instructions carefully before beginning installation.

Total System Components – Nominal 3/32" thick, 4' wide panels, harmonizing FRP Trim Molding, adhesives, silicone sealant, Marlite brand patented FRP Base Molding System.

Tools Required – Table saw or circular saw with fine-tooth blade, caulking gun, rule/tape, drill, file, hammer, laser level, horses/support.

Caution – Use a damp cloth, mild soap or detergent to clean panels. Use mineral spirits to remove excess adhesive before it dries. Do not use abrasive cleaners.

Open package – Carefully inspect all panels. Due to manufacturing techniques, some panels may possess minor variations in color consistency and pattern.

Installation Tips

1. Install Artizan™ Max FRP Panels when room and material temperature are approximately 70°F.
2. Application is recommended over a solid backing, such as drywall or plywood. Surface to be covered must be clean, dry, solid, straight, and free from drywall dust, bumps, projections, loose plaster, loose paint, or any unsealed joint compound wider than 3". ***For seams with excessive joint compound wider than 3", seal drywall joint using a 50/50 mixture of latex paint and water applied lightly over the dry wall compound only.***
3. Maintain plumb vertical edges with plumb lines or level.
4. Do not position Artizan™ Max FRP Panel joints directly over drywall or plywood joints.
5. Cut Artizan™ Max FRP Panels face up using a table saw or face down using a circular saw.
6. When using Marlite brand C-551 FRP Adhesive, use only unfinished, untreated plywood or unfinished, untreated drywall.
7. For application over ceramic tile, block wall or existing FRP panels, Advanced Polymer Adhesive is required due to the subwall's non-porous surface.

Condition Panels

FRP Panels should be allowed to acclimate to the room environment prior to installation. After unpacking, place panels in the room where they will be installed for at least 48 hours prior to installation.

Important! Regarding High Humidity Areas:

For applications that require silicone sealant, we recommend the use of Marlite brand Silicone Sealant, available in clear (MS 250) and white (MS 251). In high moisture or wet areas, Trim Molding should surround all panels and be properly sealed with a continuous bead of sealant.

Installation Steps for FRP Trim Molding

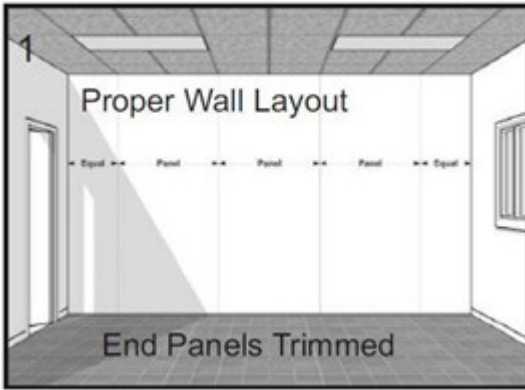

For a balanced appearance, establish a center line of area to be covered. (see illustration 1)

Trim Molding must be applied using adhesive. Do not pin tack or staple through FRP Panels.

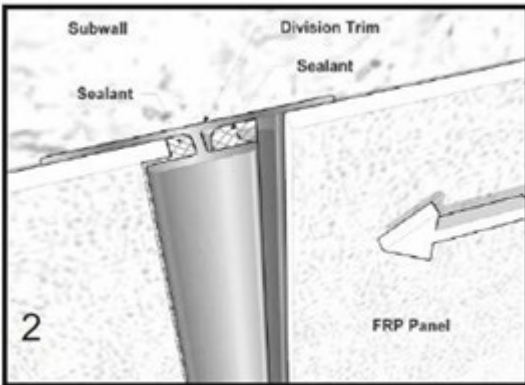

Note: Division trim molding is no longer required, but still available.

Do not fit panels too tightly into Trim Molding. Allow at least 1/8" space in all channels for panel expansion after installation is completed. (see illustration 2)

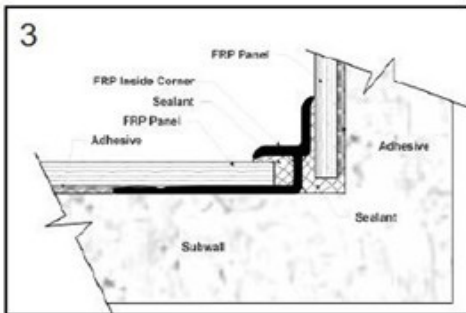

Where steam cleaning is required, and high moisture conditions are prevalent; all Trim Molding and FRP Panels must be sealed with Marlite brand Silicone Sealant to ensure a watertight seal. (see illustrations 3 – 5)

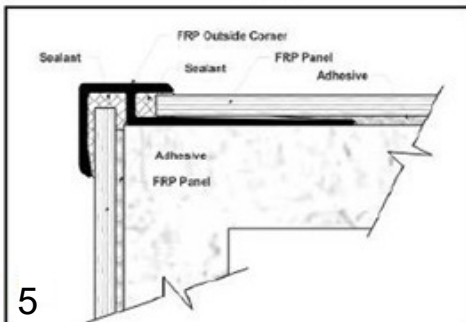
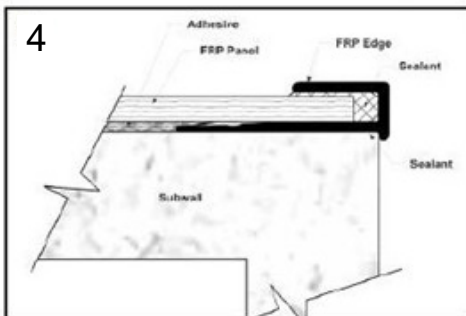

Silicone Sealant is best applied to Trim Molding prior to application to the wall. It is important that a continuous, non-broken bead of sealant is applied. Excess sealant "squeeze-out" should be promptly cleaned off with mineral spirits. It is suggested that a sealant be applied to all exposed edges of molding, electric plates and other covers after installation. Allow 24 hours drying time for sealant. Rough cut FRP Panel edges can be smoothed with sandpaper or a file.

Application at Tile Curb, Floor, Base Molding and Ceiling Line

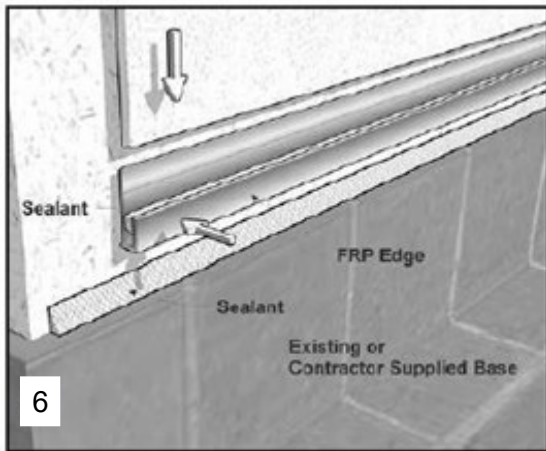

Curb must be installed first. For high moisture areas, apply a continuous bead of silicone sealant to the top of curb or floor line and in the Trim Molding channel. Set Edge Trim Molding in place and fasten to the sub wall. Slip FRP Panel into Edge Trim Molding. Execute similar application at ceiling line. (see illustration 6)

Application at Inside Corner

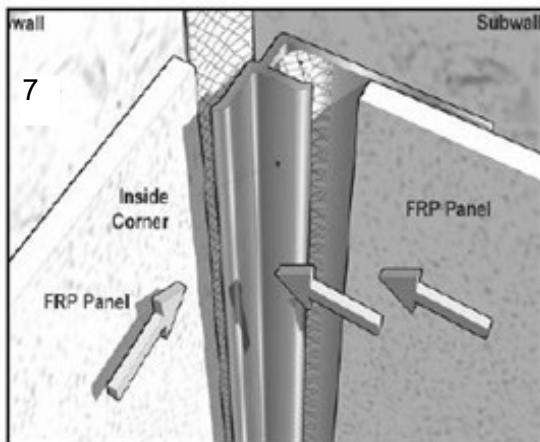

For high moisture areas, apply a continuous bead of silicone sealant in the corner and in the Inside Corner Trim Molding channel. Secure Inside Corner Trim Molding to cover bead. (see illustration 7)

Application at Outside Corner

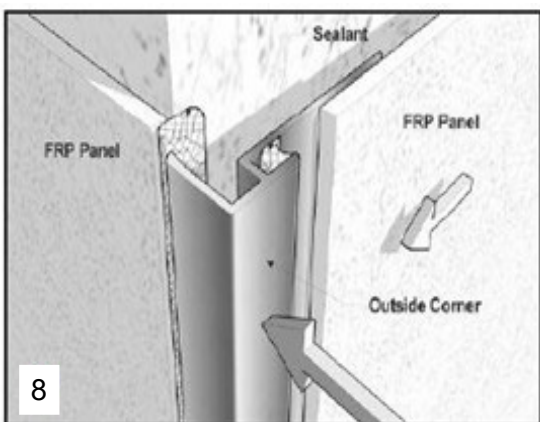

First, cut the FRP Panel on the preceding wall flush to the outside corner and install. For high moisture areas, apply a continuous bead of silicone sealant to both Outside Corner Trim Molding channels. Secure into place and slip in the next FRP Panel. (see illustration 8)

M961 Outside Corner Guards and F560SS snap on Stainless Steel Corner Guards are also available for areas requiring greater durability.

Seamless Panel-to-Panel Application

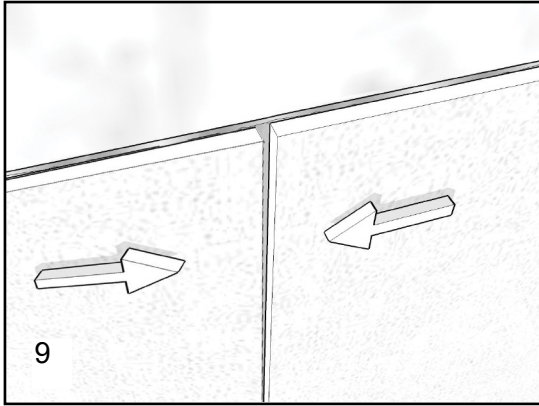

Artizan Max FRP Panels can be applied using Division Trim or, to maximize visual appeal, using a panel-to-panel joinery method. Each Artizan Max panel is factory cut square on all four sides to ensure a more seamless appearance by sliding the panels flush together.

It is important that the plumb line is straight, and the adhesive is applied within one inch of the panel edge. If adhesive squeezes onto the face of the panel, be sure to remove the excess adhesive immediately using mineral spirits. Do not allow adhesive on the panel face to dry.

Be sure to roll each panel thoroughly – especially at the panel seams – to ensure a good adhesive bond between surfaces. As each subsequent panel is applied, it is a good practice to re-roll the previous panel.

Application of Patented FRP Base Molding

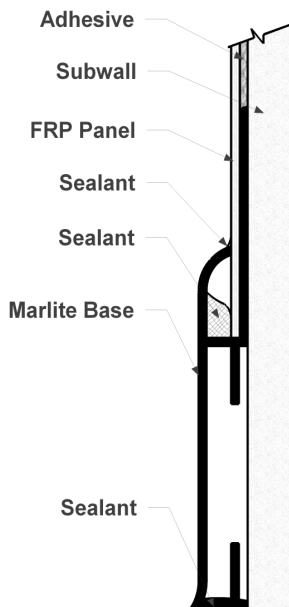

For perspective of application, see illustration 1.

Locate the highest point of the floor and mark a level reference line around the room to guide the installation.

Start at door opening.

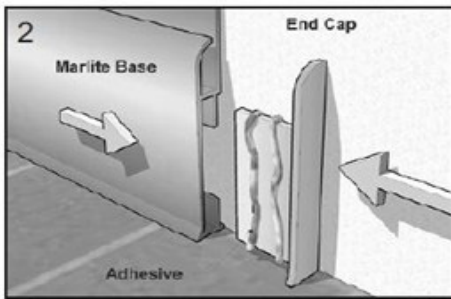

Apply ¼" bead of Marlite brand Silicone MS250 Clear Silicone Sealant to top, face and bottom of End Cap. Attach End Cap to Base Molding. A sufficient amount of sealant must be applied, creating some "squeeze out" ensuring a moisture proof seam when End Cap is applied to the Base Molding.
(see illustration 2)

Apply a ¼" bead of silicone sealant to the bottom of the Base Molding. A sufficient amount of sealant must be applied, creating some "squeeze out" when Base Molding is set in place. Set Base Molding in place using silicone sealant and nail through the back flange every 24" using 1-3/8" drywall nails.

Continue to install Base Molding using silicone sealant to attach Butt Joint Connectors, Inside Corners and Outside Corners. Apply a ¼" bead of silicone sealant to the face, top and bottom of all male connectors.

(see illustrations 3 – 5)

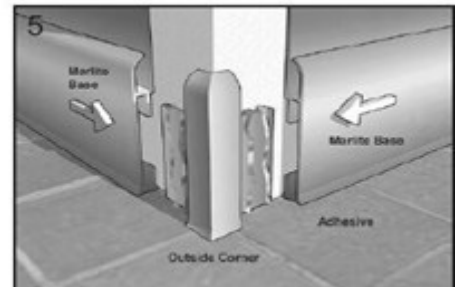
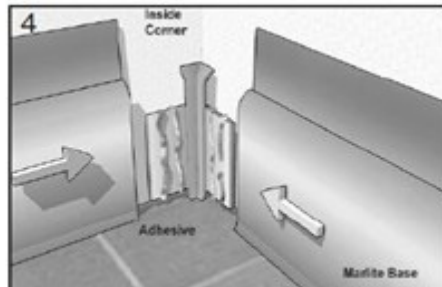
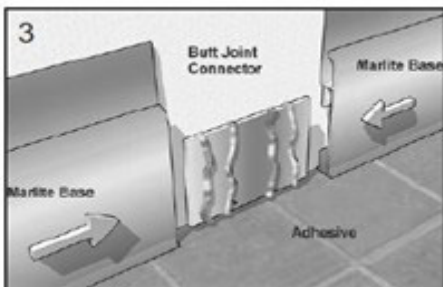

Cutting FRP Panels

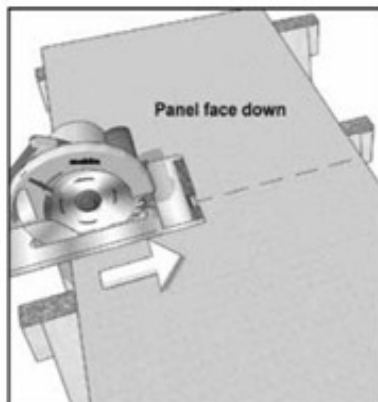
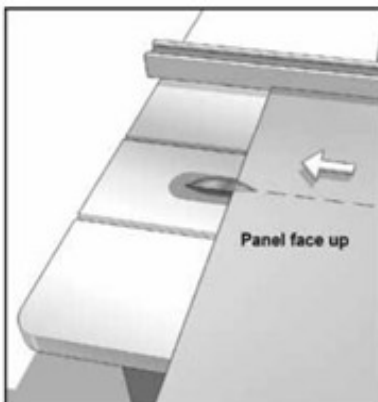

For a clean look use a new blade when cutting panels.

Cut FRP Panels face up with a table saw or face down with a circular saw using a fine-tooth blade. For cutouts, drill four holes and radius all corner cuts to avoid chipping. For small jobs, FRP Panels can be cut using a strong pair of cutting shears.

If slight chipping occurs on cut edge, use a sanding block and lightly touch the edges at an angle to create a clean appearance.

Application of Adhesive

Always apply Marlite brand C-551 FRP Adhesive, Marlite brand C-915 Construction Adhesive or Advanced Polymer Adhesive to the FRP Panel back. Be sure the existing sub wall is porous, straight, clean, and dry. Apply over plywood or drywall that is void of excessive joint compound.

If the sub wall is non-porous, Marlite brand 915 Construction Adhesive or Advanced Polymer Adhesive must be used. Perform a trial to ensure acceptable adhesion and performance. Adhesive is easiest to spread at approximately 70°F. FRP Panels must be installed while the adhesive is fresh, within 5 minutes of application. **Adhesive on the FRP Panel face should be removed promptly using mineral spirits.** Adhesive coverage is 210 square feet per 3.5 gallon can.

Apply adhesive to the entire back of the FRP Panel using a notched spreader or trowel. Trowel size is 3/16" wide x 1/4" deep x 1/2" center-to-center notch.

100% coverage over the entire FRP Panel back is required except approximately 1" at edges. Use the notches in the spreader to achieve the exact depth of adhesive. The spreader end must be kept at 90° to the panel surface. Avoid too heavy a coat. To assure proper ridges when spreading adhesive, keep notches of the spreader clean. (see illustration 1-A). Once FRP Panel is adhered to wall, apply pressure by rolling (see illustration 1-B). Be sure of 100% adhesive transfer.

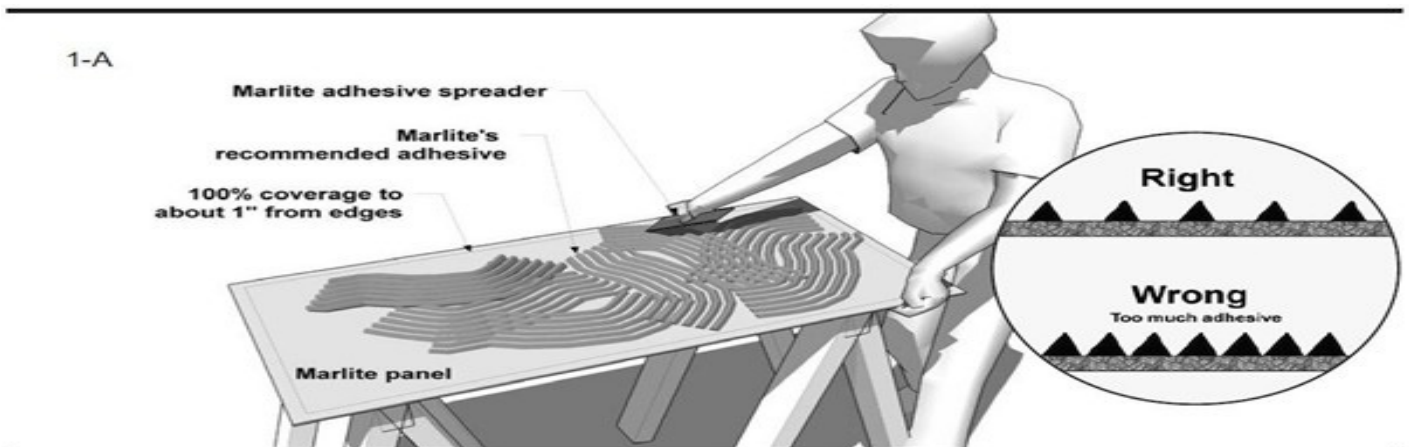

Use Marlite brand C-551 FRP Adhesive (sub wall must be porous) or the Advanced Polymer Adhesive to satisfy low VOC requirements

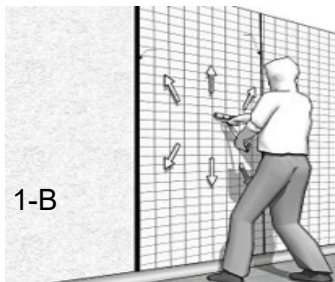

Excessive Drywall Compound

If using Marlite brand C-551 FRP Adhesive, seal excessive drywall compound (see page 1 installation tip #2). Walls that have excessive joint compound wider than 3" should be sealed with a 50/50 mixture of latex paint and water prior to installing FRP Panels. Walls should not be painted. Failure to follow these requirements may result in installation failure.