



ARTIZAN™ MAX FRP Installation Instructions

Statements expressed in this technical bulletin are recommendations for the application of Marlite brand products as outlined and illustrated under normal conditions of installation. The recommendations provided in the bulletin represent our best judgment based on our experience with normal applications. Unless prior approval is obtained in writing from Marlite, any deviation from these recommended procedures shall be at the sole risk of the installers. Carefully inspect all panels. If a panel is defective, notify the Marlite Service Center or Distributor nearest you at once. Failure to do so shall be at the sole risk of the installer. Do not store Marlite Artizan™ Max FRP Panels outside exposed to the weather and its elements.

Important – Read complete instructions carefully before beginning installation.

Total System Components – Nominal 3/32" thick, 4' wide panels, harmonizing FRP Trim Molding, adhesives, silicone sealant, Marlite brand patented FRP Base Molding System.

Tools Required – Table saw or circular saw with fine-tooth blade, caulking gun, rule/tape, drill, file, hammer, laser level, horses/support.

Caution – Use a damp cloth, mild soap or detergent to clean panels. Use mineral spirits to remove excess adhesive before it dries. Do not use abrasive cleaners.

Open package – Carefully inspect all panels. Due to manufacturing techniques, some panels may possess minor variations in color consistency and pattern.

Installation Tips

1. Install Artizan™ Max FRP Panels when room and material temperature are approximately 70°F.
2. Application is recommended over a solid backing, such as drywall or plywood. Surface to be covered must be clean, dry, solid, straight, and free from drywall dust, bumps, projections, loose plaster, loose paint, or any unsealed joint compound wider than 3". ***For seams with excessive joint compound wider than 3", seal drywall joint using a 50/50 mixture of latex paint and water applied lightly over the drywall compound only.***
3. Maintain plumb vertical edges with plumb lines or level.
4. Do not position Artizan™ Max FRP Panel joints directly over drywall or plywood joints.
5. Cut Artizan™ Max FRP Panels face up using a table saw or face down using a circular saw.
6. When using Marlite brand C-551 FRP Adhesive, use only unfinished, untreated plywood or unfinished, untreated drywall.
7. For application over ceramic tile, block wall or existing FRP panels, Advanced Polymer Adhesive is required due to the subwall's non-porous surface.

Condition Panels

Artizan™ Max FRP Panels should be allowed to acclimate to the room environment prior to installation. After unpacking, place panels in the room where they will be installed for at least 48 hours prior to installation.

Important! Regarding High Humidity Areas:

For applications that require silicone sealant, we recommend the use of Marlite brand Silicone Sealant, available in clear (MS 250) and white (MS 251). In high moisture or wet areas, Trim Molding should surround all panels and be properly sealed with a continuous bead of sealant.

Installation Steps for FRP Trim Molding

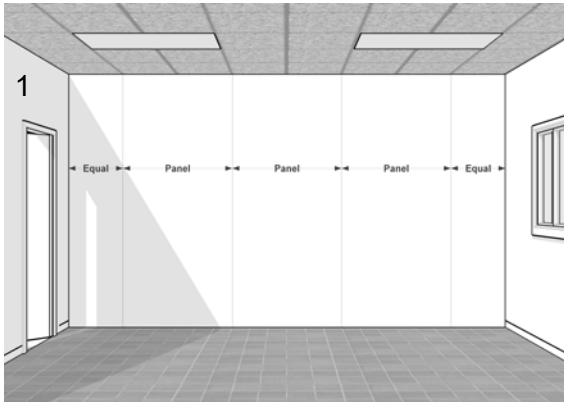

For a balanced appearance, establish a center line of area to be covered. (see illustration 1)

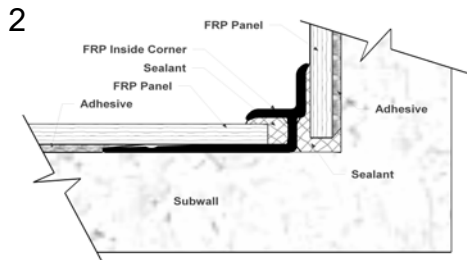

Where steam cleaning is required, and high moisture conditions are prevalent; all Trim Molding and FRP Panels must be sealed with Marlite brand Silicone Sealant to ensure a watertight seal. (see illustrations 2 – 4)

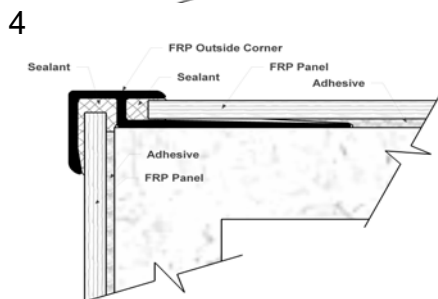
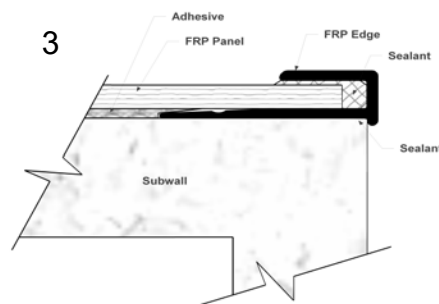

Silicone Sealant is best applied to Trim Molding prior to application to the wall. It is important that a continuous, non-broken bead of sealant is applied. Excess sealant "squeeze-out" should be promptly cleaned off with mineral spirits. It is suggested that a sealant be applied to all exposed edges of molding, electric plates and other covers after installation. Allow 24 hours drying time for sealant. Rough cut Artizan™ Max FRP Panel edges can be smoothed with sandpaper or a file.

Application at Tile Curb, Floor, Base Molding and Ceiling Line

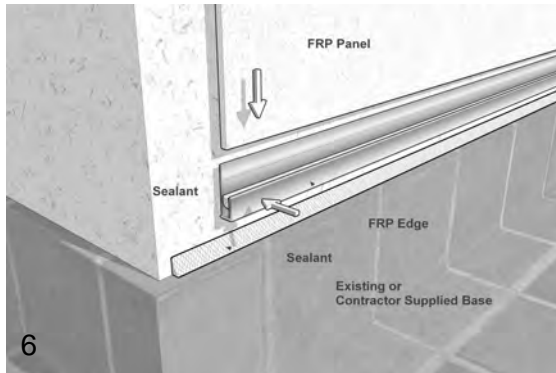

Curb must be installed first. For high moisture areas, apply a continuous bead of silicone sealant to the top of curb or floor line and in the Trim Molding channel. Set Edge Trim Molding in place and fasten to the sub wall. Slip FRP Panel into Edge Trim Molding. Execute similar application at ceiling line. (see illustration 6)

Application at Inside Corner

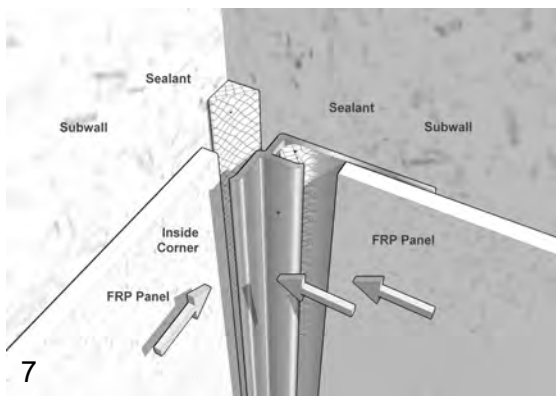

For high moisture areas, apply a continuous bead of silicone sealant in the corner and in the Inside Corner Trim Molding channel. Secure Inside Corner Trim Molding to cover bead. (see illustration 7)

Application at Outside Corner

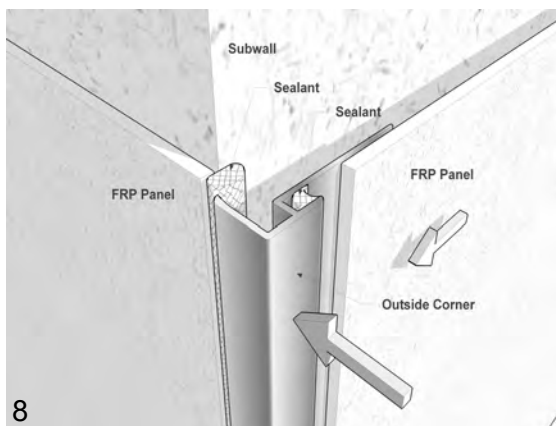

First, cut the FRP Panel on the preceding wall flush to the outside corner and install. For high moisture areas, apply a continuous bead of silicone sealant to both Outside Corner Trim Molding channels. Secure into place and slip in the next FRP Panel. (see illustration 8)

M961 Outside Corner Guards and F560SS snap on Stainless Steel Corner Guards are also available for areas requiring greater durability.

Seamless Panel-to-Panel Application

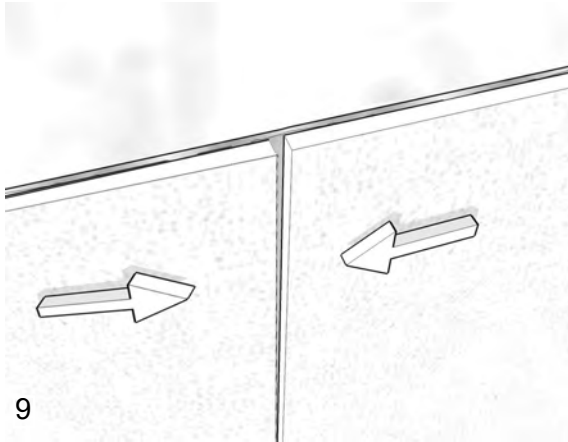

Artizan Max FRP Panels can be applied using Division Trim or, to maximize visual appeal, using a panel-to-panel joinery method. Each Artizan Max panel is factory cut square on all four sides to ensure a more seamless appearance by sliding the panels flush together.

It is important that the plumb line is straight, and the adhesive is applied within one inch of the panel edge. If adhesive squeezes onto the face of the panel, be sure to remove the excess adhesive immediately using mineral spirits. Do not allow adhesive on the panel face to dry.

Be sure to roll each panel thoroughly – especially at the panel seams – to ensure a good adhesive bond between surfaces. As each subsequent panel is applied, it is a good practice to re-roll the previous panel.

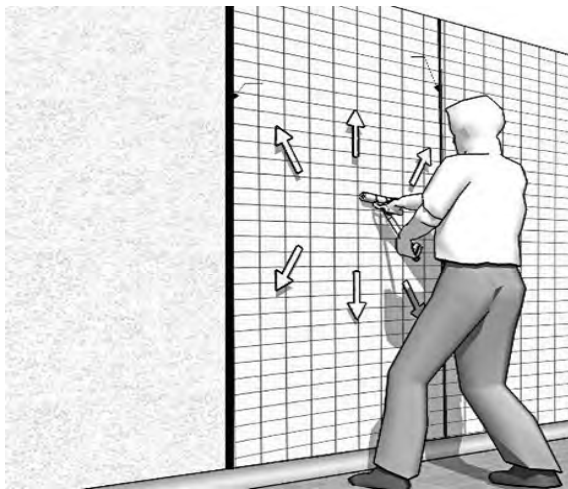

If using Trim Moldings they must be applied using adhesive or sealant. Do not pin tack or staple through FRP Panels.

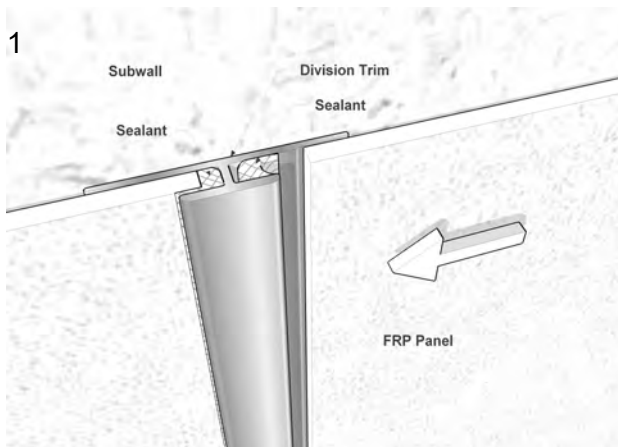

Note: Division trim molding is no longer required, but still available.

Do not fit panels too tightly into Trim Molding. Allow at least 1/8" space in all channels for panel expansion after installation is completed. (see illustration 1)

Application of Patented FRP Base Molding

2

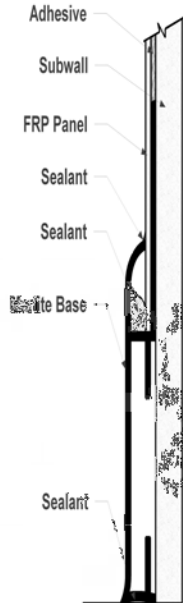

For perspective of application, see illustration 2.

Locate the highest point of the floor and mark a level reference line around the room to guide the installation.

Start at door opening.

3

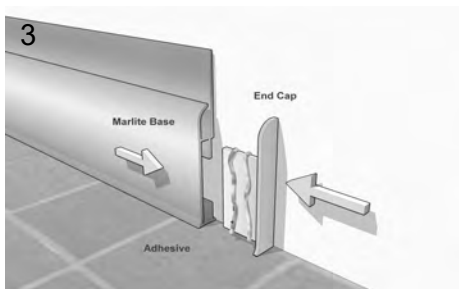

Apply 1/4" bead of Marlite brand Silicone MS250 Clear Silicone Sealant to top, face and bottom of End Cap. Attach End Cap to Base Molding. A sufficient amount of sealant must be applied, creating some "squeeze out" ensuring a moisture proof seam when End Cap is applied to the Base Molding. (see illustration 3)

Apply a 1/4" bead of silicone sealant to the bottom of the Base Molding. A sufficient amount of sealant must be applied, creating some "squeeze out" when Base Molding is set in place. Set Base Molding in place using silicone sealant and nail through the back flange every 24" using 1-3/8" drywall nails.

Continue to install Base Molding using silicone sealant to attach Butt Joint Connectors, Inside Corners and Outside Corners. Apply a 1/4" bead of silicone sealant to the face, top and bottom of all male connectors.

(see illustrations 4 – 6)

4

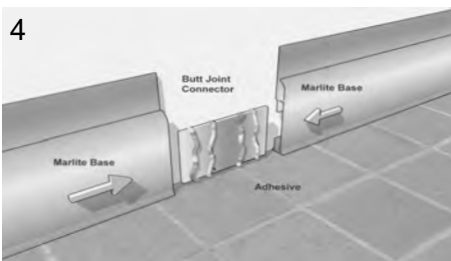

5

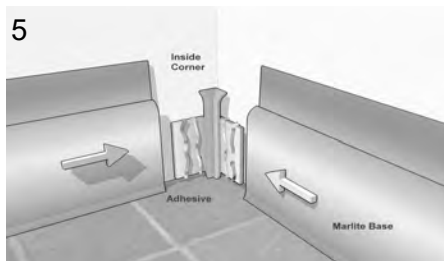

6

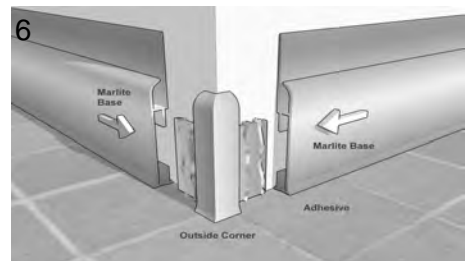

Cutting FRP Panels

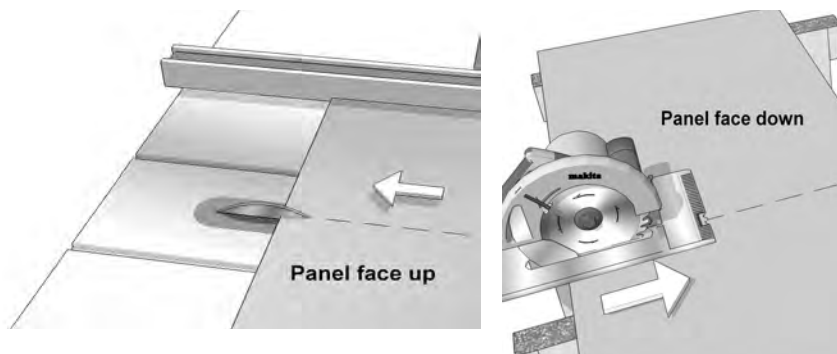

If slight chipping occurs from field cuts, ease the edges lightly using a sanding block.

For a clean cut use a new blade when cutting panels.

Cut Artizan™ Max FRP Panels face up with a table saw or face down with a circular saw using a fine-tooth blade. For cutouts, drill four holes and radius all corner cuts to avoid chipping. For small jobs, FRP Panels can be cut using a strong pair of cutting shears.

Application of Adhesive

Always apply Marlite brand C-551 FRP Adhesive or Advanced Polymer Adhesive to the Artizan™ Max FRP Panel back. Be sure the existing sub wall is porous, straight, clean, and dry. Apply over plywood or drywall that is void of excessive joint compound.

If the sub wall is non-porous, Advanced Polymer Adhesive must be used. Perform a trial to ensure acceptable adhesion and performance. Adhesive is easiest to spread at approximately 70°F. FRP Panels must be installed while the adhesive is fresh, within 5 minutes of application. ***Adhesive on the FRP Panel face should be removed promptly using mineral spirits.*** Adhesive coverage is 210 square feet per 3.5 gallon can.

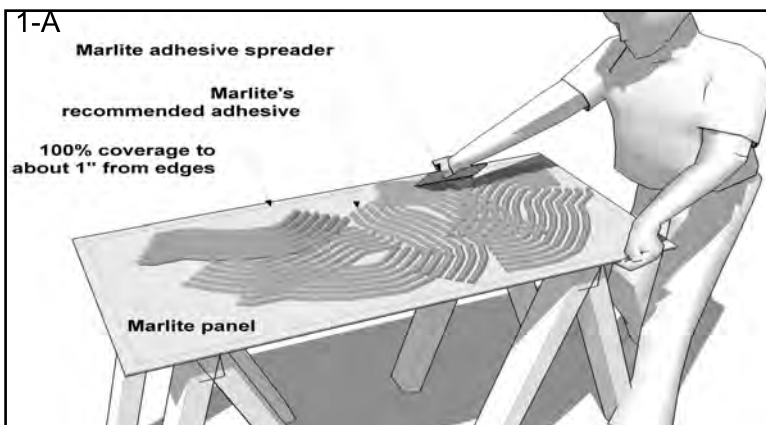

Apply adhesive to the entire back of the FRP Panel using a notched spreader or trowel. Trowel size is 3/16" wide x 1/4" deep x 1/2" center-to-center notch.

100% coverage over the entire FRP Panel back is required except approximately 1" at edges. Use the notches in the spreader to achieve the exact depth of adhesive. The spreader end must be kept at 90° to the panel surface. Avoid too heavy a coat. To assure proper ridges when spreading adhesive, keep notches of the spreader clean. (see illustration 1-A). Once FRP Panel is adhered to wall, apply pressure by rolling (see illustration 1-B). Be sure of 100% adhesive transfer.

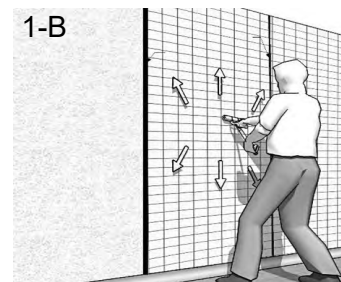

Use Marlite brand C-551 FRP Adhesive (sub wall must be porous) or the Advanced Polymer Adhesive to satisfy low VOC requirements.

Excessive Drywall Compound

If using Marlite brand C-551 FRP Adhesive, seal excessive drywall compound (see page 1 installation tip #2). Walls that have excessive joint compound wider than 3" should be sealed with a 50/50 mixture of latex paint and water prior to installing FRP Panels. Walls should not be painted. Failure to follow these requirements may result in installation failure.